

di Vecchi Ivan Alessandro e C.
 Viale Europa, 6 - 24040 Bottanuco (BG) Italy
 P.Iva 01470300169
 N. Iscr. Registro Imprese di Bergamo e Cod. Fisc.: 01470300169
 R.E.A. di Bergamo n. 208600 - N° Albo Artigiani BG - 78898
[http:// www.fratellivecchi.it](http://www.fratellivecchi.it)
 E-mail: info@fratellivecchi.it

SMS



Art. 120/S

Tee standard satinati esternamente e satinati internamente:
 Expanding tee external satin poolishing / internal satin poolishing

D	B	COD.ART.	COD.ART.
		304L	316L
25,4x1,5	55	120S-25,4.4	120S-25,4.6
38,1x1,5	70	120S-38,1.4	120S-38,1.6
50,8x1,5	72	120S-50,8.4	120S-50,8.6
63,5x1,5	105	120S-63,5.4	120S-63,5.6
76,1x2	110	120S-76,1.4	120S-76,1.6
101,6x2	150	120S-101,6.4	120S-101,6.6
104x2	150	120S-104.4	120S-104.6

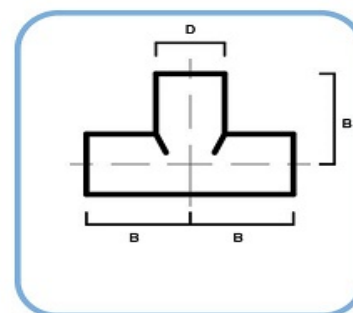

Art. 140/SC

Croci standard satinare esternamente e satinare internamente:
 Expanding cross external satin poolishing / internal satin poolishing

D	B	COD.ART.	COD.ART.
		304L	316L
25,4x1,5	55	140SC-25,4.4	140SC-25,4.6
38,1x1,5	70	140SC-38,1.4	140SC-38,1.6
50,8x1,5	72	140SC-50,8.4	140SC-50,8.6
63,5x1,5	105	140SC-63,5.4	140SC-63,5.6
76,1x2	110	140C-76,1.4	140SC-76,1.6
101,6x2	150	140C-101,6.4	140SC-101,6.6
104x2	150	140C-104.4	140SC-104.6

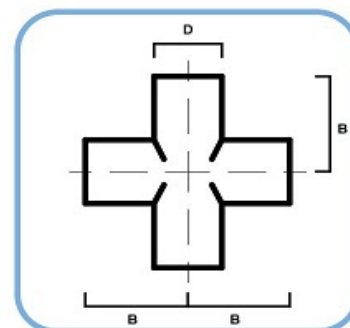

Art. 160/SE

Tee solo estrusi satinati esternamente e satinati internamente:
 Welding tee short external satin poolishing / internal satin poolishing

D	B	COD.ART.	COD.ART.
		304L	316L
25,4x1,5	55	160SE-25,4.4	160SE-25,4.6
38,1x1,5	70	160SE-38,1.4	160SE-38,1.6
50,8x1,5	72	160SE-50,8.4	160SE-50,8.6
63,5x1,5	105	160SE-63,5.4	160SE-63,5.6
76,1x2	110	160SE-76,1.4	160SE-76,1.6
101,6x2	150	160SE-101,6.4	160SE-101,6.6
104x2	150	160SE-104.4	160SE-104.6

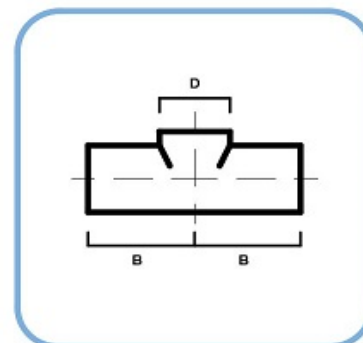

Art. 150/SP

Tee standard ridotti satinati esternamente e satinati internamente:
Reducing tee external satin polishing / internal satin polishing

D	B		COD.ART.	
			304L	316L
25,4	12,7	55	150SP-25,4/12,7.4	150SP-25,4/12,7.6
	19,1		150SP-25,4/19,1.4	150SP-25,4/19,1.6
38,1	12,7	70	150SP-38,1/12,7.4	150SP-38,1/12,7.6
	19,1		150SP-38,1/19,1.4	150SP-38,1/19,1.6
	25,4		150SP-38,1/25,4.4	150SP-38,1/25,4.6
50,8	12,7	72	150SP-50,8/12,7.4	150SP-50,8/12,7.6
	19,1		150SP-50,8/19,1.4	150SP-50,8/19,1.6
	25,4		150SP-50,8/25,4.4	150SP-50,8/25,4.6
	38,1		150SP-50,8/38,1.4	150SP-50,8/38,1.6
63,5	12,7	105	150SP-63,5/12,7.4	150SP-63,5/12,7.6
	19,1		150SP-63,5/19,1.4	150SP-63,5/19,1.6
	25,4		150SP-63,5/25,4.4	150SP-63,5/25,4.6
	38,1		150SP-63,5/38,1.4	150SP-63,5/38,1.6
	50,8		150SP-63,5/50,8.4	150SP-63,5/50,8.6
76,1	12,7	110	150SP-76,1/12,7.4	150SP-76,1/12,7.6
	19,1		150SP-76,1/19,1.4	150SP-76,1/19,1.6
	25,4		150SP-76,1/25,4.4	150SP-76,1/25,4.6
	38,1		150SP-76,1/38,1.4	150SP-76,1/38,1.6
	50,8		150SP-76,1/50,8.4	150SP-76,1/50,8.6
	63,5		150SP-76,1/63,5.4	150SP-76,1/63,5.6
101,6	12,7	150	150SP-101,6/12,7.4	150SP-101,6/12,7.6
	19,1		150SP-101,6/19,1.4	150SP-101,6/19,1.6
	25,4		150SP-101,6/25,4.4	150SP-101,6/25,4.6
	38,1		150SP-101,6/38,1.4	150SP-101,6/38,1.6
	50,8		150SP-101,6/50,8.4	150SP-101,6/50,8.6
	63,5		150SP-101,6/63,5.4	150SP-101,6/63,5.6
	76,1		150SP-101,6/76,1.4	150SP-101,6/76,1.6
104	12,7	150	150SP-104/12,7.4	150SP-104/12,7.6
	19,1		150SP-104/19,1.4	150SP-104/19,1.6
	25,4		150SP-104/25,4.4	150SP-104/25,4.6
	38,1		150SP-104/38,1.4	150SP-104/38,1.6
	50,8		150SP-104/50,8.4	150SP-104/50,8.6
	63,5		150SP-104/63,5.4	150SP-104/63,5.6
	76,1		150SP-104/76,1.4	150SP-104/76,1.6
	101,6		150SP-104/101,6.4	150SP-104/101,6.6

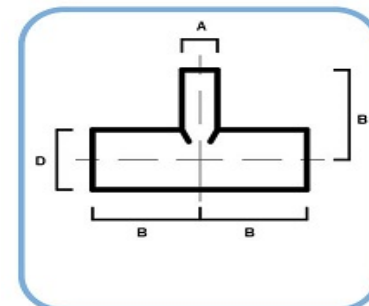

Art. 180/SP

Tee ridotti solo estrusi satinati esternamente e satinati internamente:
Reducing tee short welding external satin polishing / internal satin polishing

D	B		COD.ART.	
			304L	316L
25,4	12,7	55	180SP-25,4/12,7,4	180SP-25,4/12,7,6
	19,1		180SP-25,4/19,1,4	180SP-25,4/19,1,6
38,1	12,7	70	180SP-38,1/12,7,4	180SP-38,1/12,7,6
	19,1		180SP-38,1/19,1,4	180SP-38,1/19,1,6
	25,5		180SP-38,1/25,4,4	180SP-38,1/25,4,6
50,8	12,7	72	180SP-50,8/12,7,4	180SP-50,8/12,7,6
	19,1		180SP-50,8/19,1,4	180SP-50,8/19,1,6
	25,5		180SP-50,8/25,5,4	180SP-50,8/25,5,6
	38,1		180SP-50,8/38,1,4	180SP-50,8/38,1,6
63,5	12,7	105	180SP-63,5/12,7,4	180SP-63,5/12,7,6
	19,1		180SP-63,5/19,1,4	180SP-63,5/19,1,6
	25,4		180SP-63,5/25,4,4	180SP-63,5/25,4,6
	38,1		180SP-63,5/38,1,4	180SP-63,5/38,1,6
	50,8		180SP-63,5/50,8,4	180SP-63,5/50,8,6
	63,5		180SP-63,5/63,5,4	180SP-63,5/63,5,6
76,1	12,7	110	180SP-76,1/12,7,4	180SP-76,1/12,7,6
	19,1		180SP-76,1/19,1,4	180SP-76,1/19,1,6
	25,4		180SP-76,1/25,4,4	180SP-76,1/25,4,6
	38,1		180SP-76,1/38,1,4	180SP-76,1/38,1,6
	50,8		180SP-76,1/50,8,4	180SP-76,1/50,8,6
	63,5		180SP-76,1/63,5,4	180SP-76,1/63,5,6
101,6	12,7	150	180SP-101,6/12,7,4	180SP-101,6/12,7,6
	19,1		180SP-101,6/19,1,4	180SP-101,6/19,1,6
	25,4		180SP-101,6/25,4,4	180SP-101,6/25,4,6
	38,1		180SP-101,6/38,1,4	180SP-101,6/38,1,6
	50,8		180SP-101,6/50,8,4	180SP-101,6/50,8,6
	63,5		180SP-101,6/63,5,4	180SP-101,6/63,5,6
	76,1		180SP-101,6/76,1,4	180SP-101,6/76,1,6
104	12,7	150	180SP-104/12,7,4	180SP-104/12,7,6
	19,1		180SP-104/19,1,4	180SP-104/19,1,6
	25,4		180SP-104/25,4,4	180SP-104/25,4,6
	38,1		180SP-104/38,1,4	180SP-104/38,1,6
	50,8		180SP-104/50,8,4	180SP-104/50,8,6
	63,5		180SP-104/63,5,4	180SP-104/63,5,6
	76,1		180SP-104/76,1,4	180SP-104/76,1,6
	101,6		180SP-104/101,6,4	180SP-104/101,6,6

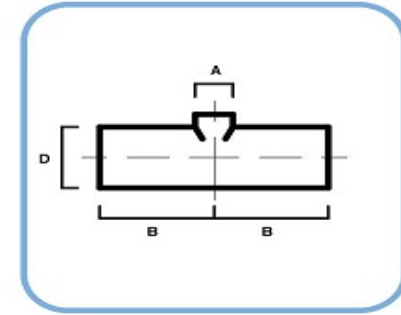

Art. 260/SP

Croci ridotte saldate satinare esternamente e satinati internamente:
Reducing cross welded external satin polishing / internal satin polishing

D	B		COD.ART.	
			304L	316L
25,4	12,7	55	260SP-25,4/12,7,4	260SP-25,4/12,7,6
	19,1		260SP-25,4/19,1,4	260SP-25,4/19,1,6
38,1	12,7	70	260SP-38,1/12,7,4	260SP-38,1/12,7,6
	19,1		260SP-38,1/19,1,4	260SP-38,1/19,1,6
	25,5		260SP-38,1/25,4,4	260SP-38,1/25,4,6
50,8	12,7	72	260SP-50,8/12,7,4	260SP-50,8/12,7,6
	19,1		260SP-50,8/19,1,4	260SP-50,8/19,1,6
	25,5		260SP-50,8/25,5,4	260SP-50,8/25,5,6
	38,1		260SP-50,8/38,1,4	260SP-50,8/38,1,6
63,5	12,7	105	260SP-63,5/12,7,4	260SP-63,5/12,7,6
	19,1		260SP-63,5/19,1,4	260SP-63,5/19,1,6
	25,4		260SP-63,5/25,4,4	260SP-63,5/25,4,6
	38,1		260SP-63,5/38,1,4	260SP-63,5/38,1,6
	50,8		260SP-63,5/50,8,4	260SP-63,5/50,8,6
	63,5		260SP-63,5/63,5,4	260SP-63,5/63,5,6
76,1	12,7	110	260SP-76,1/12,7,4	260SP-76,1/12,7,6
	19,1		260SP-76,1/19,1,4	260SP-76,1/19,1,6
	25,4		260SP-76,1/25,4,4	260SP-76,1/25,4,6
	38,1		260SP-76,1/38,1,4	260SP-76,1/38,1,6
	50,8		260SP-76,1/50,8,4	260SP-76,1/50,8,6
	63,5		260SP-76,1/63,5,4	260SP-76,1/63,5,6
101,6	12,7	150	260SP-101,6/12,7,4	260SP-101,6/12,7,6
	19,1		260SP-101,6/19,1,4	260SP-101,6/19,1,6
	25,4		260SP-101,6/25,4,4	260SP-101,6/25,4,6
	38,1		260SP-101,6/38,1,4	260SP-101,6/38,1,6
	50,8		260SP-101,6/50,8,4	260SP-101,6/50,8,6
	63,5		260SP-101,6/63,5,4	260SP-101,6/63,5,6
	76,1		260SP-101,6/76,1,4	260SP-101,6/76,1,6
104	12,7	150	260SP-104/12,7,4	260SP-104/12,7,6
	19,1		260SP-104/19,1,4	260SP-104/19,1,6
	25,4		260SP-104/25,4,4	260SP-104/25,4,6
	38,1		260SP-104/38,1,4	260SP-104/38,1,6
	50,8		260SP-104/50,8,4	260SP-104/50,8,6
	63,5		260SP-104/63,5,4	260SP-104/63,5,6
	76,1		260SP-104/76,1,4	260SP-104/76,1,6
	101,6		260SP-104/101,6,4	260SP-104/101,6,6

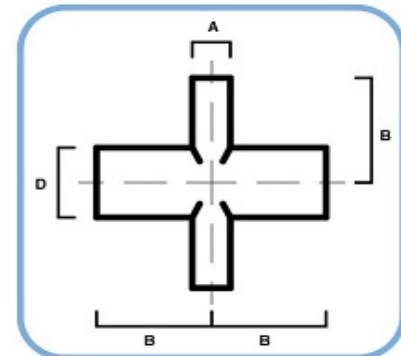

Art. 270/SP

Croci ridotte stampate satinare esternamente e satinati internamente:

Reducing cross short welded external satin polishing / internal satin polishing

D	B		COD.ART.	
			304L	316L
25,4	12,7	55	270SP-25,4/12,7,4	270SP-25,4/12,7,6
	19,1		270SP-25,4/19,1,4	270SP-25,4/19,1,6
38,1	12,7	70	270SP-38,1/12,7,4	270SP-38,1/12,7,6
	19,1		270SP-38,1/19,1,4	270SP-38,1/19,1,6
	25,5		270SP-38,1/25,4,4	270SP-38,1/25,4,6
50,8	12,7	72	270SP-50,8/12,7,4	270SP-50,8/12,7,6
	19,1		270SP-50,8/19,1,4	270SP-50,8/19,1,6
	25,5		270SP-50,8/25,5,4	270SP-50,8/25,5,6
	38,1		270SP-50,8/38,1,4	270SP-50,8/38,1,6
63,5	12,7	105	270SP-63,5/12,7,4	270SP-63,5/12,7,6
	19,1		270SP-63,5/19,1,4	270SP-63,5/19,1,6
	25,4		270SP-63,5/25,4,4	270SP-63,5/25,4,6
	38,1		270SP-63,5/38,1,4	270SP-63,5/38,1,6
	50,8		270SP-63,5/50,8,4	270SP-63,5/50,8,6
76,1	12,7	110	270SP-76,1/12,7,4	270SP-76,1/12,7,6
	19,1		270SP-76,1/19,1,4	270SP-76,1/19,1,6
	25,4		270SP-76,1/25,4,4	270SP-76,1/25,4,6
	38,1		270SP-76,1/38,1,4	270SP-76,1/38,1,6
	50,8		270SP-76,1/50,8,4	270SP-76,1/50,8,6
	63,5		270SP-76,1/63,5,4	270SP-76,1/63,5,6
101,6	12,7	150	270SP-101,6/12,7,4	270SP-101,6/12,7,6
	19,1		270SP-101,6/19,1,4	270SP-101,6/19,1,6
	25,4		270SP-101,6/25,4,4	270SP-101,6/25,4,6
	38,1		270SP-101,6/38,1,4	270SP-101,6/38,1,6
	50,8		270SP-101,6/50,8,4	270SP-101,6/50,8,6
	63,5		270SP-101,6/63,5,4	270SP-101,6/63,5,6
	76,1		270SP-101,6/76,1,4	270SP-101,6/76,1,6
104	12,7	150	270SP-104/12,7,4	270SP-104/12,7,6
	19,1		270SP-104/19,1,4	270SP-104/19,1,6
	25,4		270SP-104/25,4,4	270SP-104/25,4,6
	38,1		270SP-104/38,1,4	270SP-104/38,1,6
	50,8		270SP-104/50,8,4	270SP-104/50,8,6
	63,5		270SP-104/63,5,4	270SP-104/63,5,6
	76,1		270SP-104/76,1,4	270SP-104/76,1,6
	101,6		270SP-104/101,6,4	270SP-104/101,6,6

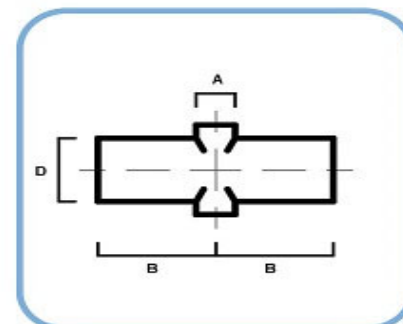

Art. 300/YS

Y 120° satinata esternamente e internamente
Y 120° satin externally and internally

DN	D	B	COD.ART.	COD.ART.
			304L	316L
25	25,4	40	300YS-25,4,4	300YS-25,4,6
38	38,1	55	300YS-38,1,4	300YS-38,1,6
51	50,8	75	300YS-50,8,4	300YS-50,8,6
63	63,5	85	300YS-63,5,4	300YS-63,5,6
76	76,1	85	300YS-76,1,4	300YS-76,1,6
101	101,6	110	300YS-101,6,4	300YS-101,6,6
104	104	110	300YS-104,4	300YS-104,6

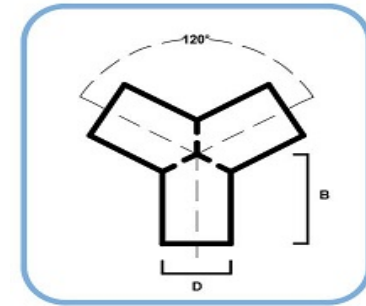

Art. 305/YS

Y 90° satinata esternamente e internamente
Y 90° satin externally and internally

DN	D	B	COD.ART.	COD.ART.
			304L	316L
25	25,4	40	305YS-25,4,4	305YS-25,4,6
38	38,1	55	305YS-38,1,4	305YS-38,1,6
51	50,8	75	305YS-50,8,4	305YS-50,8,6
63	63,5	85	305YS-63,5,4	305YS-63,5,6
76	76,1	85	305YS-76,1,4	305YS-76,1,6
101	101,6	110	305YS-101,6,4	305YS-101,6,6
104	104	110	305YS-104,4	305YS-104,6

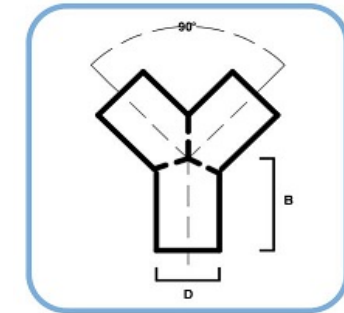

Art. 310/ES

Tee con curva satinata esternamente e internamente
Tee with bend externally and internally

DN	D	B	COD.ART.	COD.ART.
			304L	316L
25	25,4	55	310ES-25,4,4	310ES-25,4,6
38	38,1	70	310ES-38,1,4	310ES-38,1,6
51	50,8	82	310ES-50,8,4	310ES-50,8,6
63	63,5	105	310ES-63,5,4	310ES-63,5,6
76	76,1	110	310ES-76,1,4	310ES-76,1,6
101	101,6	150	310ES-101,6,4	310ES-101,6,6
104	104	150	310ES-104,4	310ES-104,6

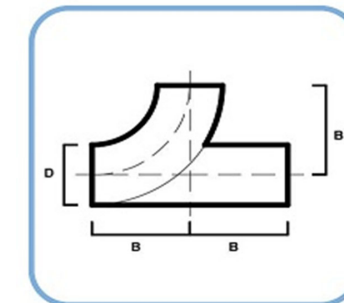

Art. 320/KD

Tee a 45° satinata esternamente e internamente
Tee 45° externally and internally

DIN	D	A	C	COD.ART.	COD.ART.
				304L	316L
25	25,4	110	95	320KD-25,4,4	320KD-12,6
38	38,1	140	105,5	320KD-38,1,4	320KD-18,6
51	50,8	175	150	320KD-50,8,4	320KD-22,6
63	63,5	210	183	320KD-63,5,4	320KD-28,6
76	76,1	220	175	320KD-76,1,4	320KD-34,6
101	101,6	300	255	320KD-101,6,4	320KD-40,6
104	104	300	259,5	320KD-104,4	320KD-52,6

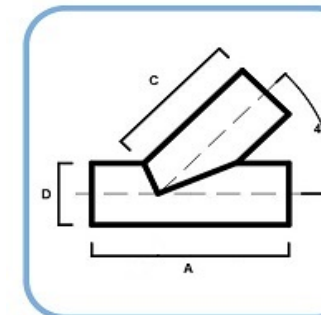

Art. 325/DC

Tee con doppia curva satinata esternamente e internamente
Tee double band externally and internally satin

D	B	COD.ART.	COD.ART.
		304L	316L
19,05x1,5	28	325DC-19,05x1,5,4	325DC-19,05x1,5,6
25,4x1,5	38	325DC-25,4x1,5,4	325DC-24,4x1,5,6
38,1x1,5	57	325DC-38,1x1,5,4	325DC-38,1x1,5,6
50,8x1,5	76	325DC-50,8x1,5,4	325DC-50,8x1,5,6
63,5x1,5	95	325DC-63,5x1,5,4	325DC-63,5x1,5,6
76,1x2	114	325DC-76,1x2,4	325DC-76,1x2,6
101,6x2	110	325DC-101,6x2,4	325DC-101,6x2,6

